

## Semray® UV3004 LED Curing Solution

A stackable, backward compatible water-cooled LED system with higher output and durability

The global printing, coating and converting market projects 3-6% growth in the next 5 years, with diverse applications in a broad range of industries from batteries to industrial coatings.

Heraeus Noblelight LED systems bring high efficiency, stability and resilience to our customers.

### Reduced downtime

More than twice expected lifetime vs. current UV lamp technologies\*

### Enhanced productivity

Increased Production uptime, even in challenging operating environments

### Backward compatibility

Easy retrofit and field replacement of existing systems

### Stackable

Flexibility in edge-to-edge mounting of LED heads to span any distance

Application: Printing, Coating & Converting including applications such as Display manufacturing, Battery film, Electronics, Medical Devices and Adhesives

\* typical service life under standard lab environmental conditions



### Product Advantages:

- Long lifetime >20,000 hours
- High intensity, robust & reliable water-cooled system
- Dimming from 40% to 100%
- Homogeneity >90% from 30 mm working distance
- Ease of handling by weight reduction of 80% compared to current UV system offerings
- Quick connect fittings for electrical and water connections

## Specifications: Semray® UV3004

### Semray® UV3004 irradiance uniformity test results:

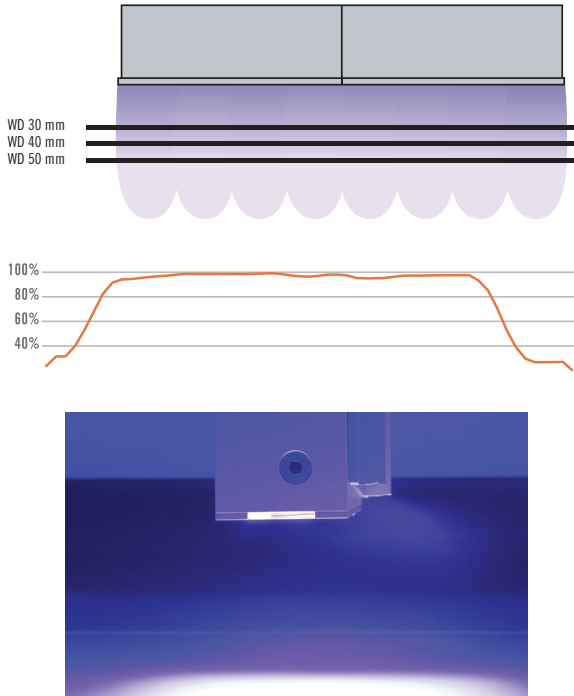

Model	UV3004 Segment			
Peak wavelength [nm]	365	385	395	405
Typical intensity at emission window [W/cm <sup>2</sup> ]	14	20	20	20
Power consumption [W]	3,200 (Max)			
Emission window (W x D) [mm]	267 x 42			
Dimensions (W x D x H) [mm]	267 x 85 x 152			
Operating temperature [°C]	10–40			
Operating humidity	80% (Max.)			
Cooling type	Water-cooled			
Coolant flow [L/min]	6–8			
Cooling water temperature [°C]	20–25			
Enclosure rating	IP54			

Germany  
**Heraeus Noblelight GmbH**  
 Reinhard-Heraeus-Ring 7  
 63801 Kleinostheim  
 Phone: +49 (6181) 35 8545  
 Fax: +49 (6181) 35 168410  
 hng-uv@heraeus.com  
 www.heraeus-noblelight.de

USA  
**Heraeus Noblelight America LLC**  
 910 Clopper Road  
 Gaithersburg, MD 20878-1357  
 Phone +1 301 527 2660  
 Fax +1 301 527 2661  
 info.hna@heraeus.com  
 www.heraeus-noblelight.com

China  
**Heraeus Noblelight (Shenyang) LTD**  
 Shanghai Branch  
 2F, No. 399 Guangzhong Road  
 Minhang District  
 Shanghai 201108, P.R. China  
 Phone +86 400 080 2255  
 Fax +86 (0) 21 3357 5333  
 info.hns@heraeus.com  
 www.heraeus-noblelight.cn

Japan  
**Heraeus K.K.**  
 Noblelight Division  
 Sumitomo Fudosan Otowa  
 Building 2F, 2-9-3  
 Otsuka, Bunkyo-ku  
 112-0012, Tokyo  
 Phone +81 3 6902 6600  
 Fax +81 3 6902 6613  
 info.hkk@heraeus.com  
 www.heraeus-noblelight.jp

### Customer Benefits:

- High productivity: significantly higher line speeds achievable
- Water cooling system eliminates expense and maintenance of cooling blowers
- Sustainable: No VOCs, CO<sub>2</sub>, ozone, and mercury free

### Power Supply

**Input Voltages:** 380–480 V ± 10%; auto-ranging.  
**Three-Phase, Delta:** 50/60 Hz.  
**Output Range:** 38–48 V.  
**Maximum Line Current:** 11 – 7 A.  
**Power Factor @ 100% Power:** 98%.  
**Dimensions (W x H x L):** 483 mm x 175 mm x 827 mm with connector (19.0 in. x 6.89 in. x 32.56 in. with connector).  
**Weight:** 16 kg (35 lbs).  
**Mounting Position:** Horizontal, standard 19 in. rack mount chassis unit can be free standing, stacked, or rack mounted.  
**Clearance:** Allow 305 mm (12 in.) rear clearance of the controller power supply for cooling air flow and cable connections. Allow 203 mm (8 in.) front clearance of the controller power supply for cooling air flow and front panel operation.  
**Stacking:** 5 units maximum.  
**Enclosure Rating:** IP20 (NEMA 1).  
**Safety Interlocks:** E-stop; 2 external interlocks (customer I/O).  
**Front Panel Indicators/Controls:** Power On/Off switch; USB port. Display unit with ON/Standby/OFF buttons and Power Level control buttons.  
**Rear Panel Connectors:** J101: AC Input power; J102: Primary/Secondary; J103: Lamp power; J106: Customer I/O; J107: E-stop; J111: Optional comm bus.  
**Power Level Control Options:** 4–20 mA; 0–10 Vdc; OR front panel.  
**Communication Methods:** Primary/Secondary (standard, dry-contact); DeviceNet™ Mark II (additional module required)\*; Profibus® DP-V1 (additional module required); ProfiNet® RT (additional module required); EtherNet/IP™ (additional module required).  
 \*Requires additional 24 V DeviceNet™ power supply.

### Power Supply Model Semray® CPS4

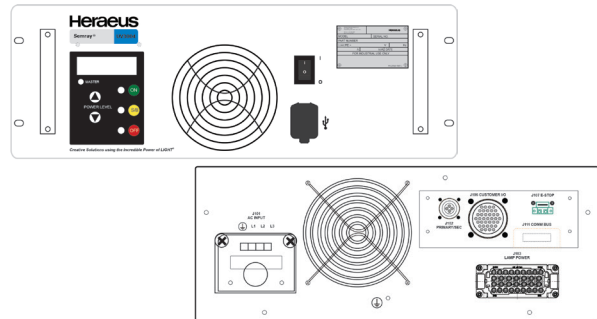

Contact your local Heraeus Noblelight office for an engineered solution for your specific requirements.

ISO 9001 Certified QMS

